







**BENCHMARK:**

BENCHMARK 1  
 5" x 8" REBAR IN CONCRETE  
 ANYTIME LOCATED  
 DURING EXCAVATION  
 REMOVE 12" DIA.  
 12" DIA.

**Utility Marking**  
 2 Working Days  
 Before You Dig  
 Call 800-367-2764 (Toll Free)  
 Ohio Utilities Protection Service  
 Non-members  
 Must Be Called Directly  
 Call 800-925-5988 (Toll Free)  
 Oil & Gas Producers Utility Protection Service

**LEGEND:**

- EXISTING EXISTING FLOOR
- EXISTING FIRE HYDRANT
- EXISTING GAS METER
- EXISTING GAS METER
- EXISTING CLEANOUT
- EXISTING CONCRETE PAD/WALKWAY/CURB
- EXISTING ROAD GRADE
- EXISTING PIPE LINE
- EXISTING PIPE
- ROCK
- DRIVEWAY
- RETAINING WALL
- DEMOLITION VEHICLE

**GENERAL SHEET NOTES:**

1. REFER TO SHEET C010 FOR GENERAL NOTES INCLUDING INFORMATION.
2. PROFILE SET FENCE AND PERIMETER CONTROLS PRIOR TO REMOVING VEGETATION AND EXISTING TOPSOIL.
3. SALVAGE AND STOCKPILE TOPSOIL FOR RE-SPREADING ON DISTURBED AREAS.

**PLAN KEYNOTES (O)**

1. THE FORMS TO BE REMOVED.
2. CLEAR BRUSH AND OTHER VEGETATION.

**DEMOLITION NOTE:**

ALL EXISTING SITE AND SURROUNDING FEATURES SUCH AS UTILITY PAYOFFS, CURB, LANDSCAPING, ETC. SHALL REMAIN AND BE PROTECTED THROUGHOUT CONSTRUCTION UNLESS NOTED OTHERWISE. ON THE REQUIRED 10% COVERED OR REDUCED TO THE SATISFACTION OF THE OWNER. ALL DEMOLITION ITEMS SHALL BE RELOCATED TO THE SITES OF THE OWNER'S CONTRACTOR SHALL BE RESPONSIBLE FOR ANY DAMAGE TO THE EXISTING UTILITIES AS A RESULT OF CONSTRUCTION ACTIVITIES AT AN ADDITIONAL COST AND TO THE SATISFACTION OF THE OWNER.



REV.	DATE	DESCRIPTION

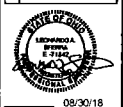

08/30/18  
**CLOVERDALE ESTATES DRAINAGE**  
 GEORGE W. METROPOLITAN ENGINEERING AUTHORITY  
 385 CENTER STREET, COLUMBUS, OHIO 43215  
**EXISTING CONDITIONS AND DEMOLITION PLAN**

ISSUED FOR	DATE
PERMIT	8/30/18
CONSTRUCTION	8/30/18
RECORD	-
DATE	7/18
NO. 2018359.02	



**A1** EXISTING CONDITIONS AND DEMOLITION PLAN  
 1" = 40'

Drawing Name: C100 180118002 - Cloverdale Drainage - Existing Conditions and Demolition Plan  
 Drawing No: 2018359.02  
 Date: 8/30/18  
 Project: 180118002 - Cloverdale Drainage - Existing Conditions and Demolition Plan

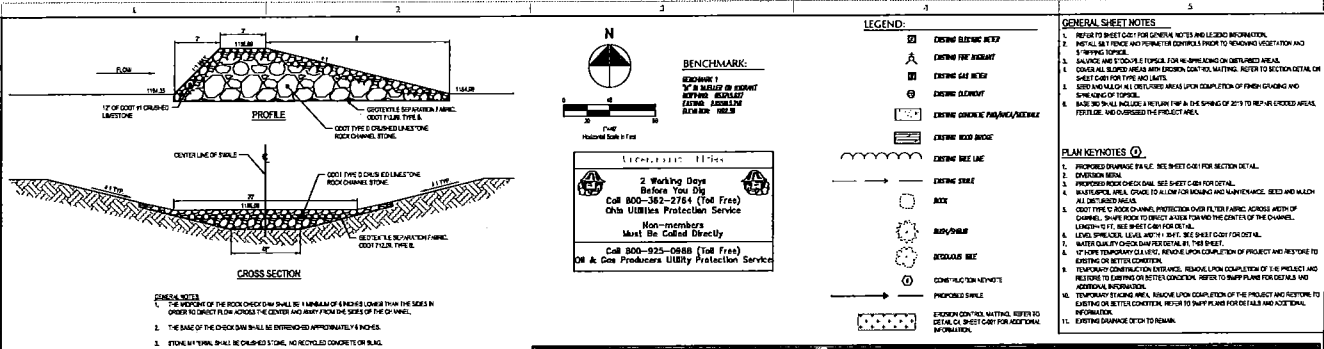

**BENCHMARK:**  
 BENCHMARK 1  
 3" x 3" METAL BY EPOCH  
 APPROX. ELEVATION  
 427.88  
 427.88  
 427.88

**Legend:**  
 [Symbol] EXISTING EXISTING RETRY  
 [Symbol] EXISTING TREE REMOVAL  
 [Symbol] EXISTING GAS METEOR  
 [Symbol] EXISTING CULVERT  
 [Symbol] EXISTING CONC RETRY/PALM/STAKE  
 [Symbol] EXISTING ROAD BRIDGE  
 [Symbol] EXISTING SIZE LANE  
 [Symbol] EXISTING DRIVE  
 [Symbol] ROAD  
 [Symbol] IMPROVEMENT  
 [Symbol] RECONSTRUCT DRIVE  
 [Symbol] CONSTRUCTION KEYNOTE  
 [Symbol] PROPOSED DRIVE

**GENERAL SHEET NOTES:**  
 1. REFER TO SHEET C01 FOR GENERAL NOTES AND ALL OTHER INFORMATION.  
 2. INSTALL ALL FENCES AND TO POST THE CONTRACT'S PRIOR TO REMOVING VEGETATION AND STUMPING LOGS.  
 3. SAVERS AND STOPS ARE TO BE PLACED ON ALL UNPAVED AREAS.  
 4. COVER ALL EXPOSED AREAS WITH EROSION CONTROL MATTING. REFER TO SECTION DETAIL ON SHEET C01 FOR THE LOG MATS.  
 5. SEED AND MULCH ALL DISTURBED AREAS UPON COMPLETION OF FINISH GRADING AND SOIL CONSERVATION.  
 6. BASE SO SHALL INCLUDE A RETURN FILL AT THE SPONGE OF 2% TO REPAIR UNEXPOSED AREAS. FERTILIZE AND SOSSER THE PROJECT AREA.  
 7. PROPOSED DRAINAGE PAVEMENT. SEE SHEET C01 FOR SECTION DETAIL.  
 8. PROPOSED ROAD ON EXISTING. SEE SHEET C01 FOR DETAIL.  
 9. IMPROVEMENT AREA. CHECK TO ALLOW FOR FINISHING AND MAINTENANCE. SEED AND MULCH ALL DISTURBED AREAS.  
 10. EXISTING DRIVE. CHECK TO ALLOW FOR FINISHING AND MAINTENANCE. SEED AND MULCH ALL DISTURBED AREAS.  
 11. EXISTING DRIVE. CHECK TO ALLOW FOR FINISHING AND MAINTENANCE. SEED AND MULCH ALL DISTURBED AREAS.  
 12. EXISTING DRIVE. CHECK TO ALLOW FOR FINISHING AND MAINTENANCE. SEED AND MULCH ALL DISTURBED AREAS.  
 13. EXISTING DRIVE. CHECK TO ALLOW FOR FINISHING AND MAINTENANCE. SEED AND MULCH ALL DISTURBED AREAS.  
 14. EXISTING DRIVE. CHECK TO ALLOW FOR FINISHING AND MAINTENANCE. SEED AND MULCH ALL DISTURBED AREAS.  
 15. EXISTING DRIVE. CHECK TO ALLOW FOR FINISHING AND MAINTENANCE. SEED AND MULCH ALL DISTURBED AREAS.  
 16. EXISTING DRIVE. CHECK TO ALLOW FOR FINISHING AND MAINTENANCE. SEED AND MULCH ALL DISTURBED AREAS.  
 17. EXISTING DRIVE. CHECK TO ALLOW FOR FINISHING AND MAINTENANCE. SEED AND MULCH ALL DISTURBED AREAS.

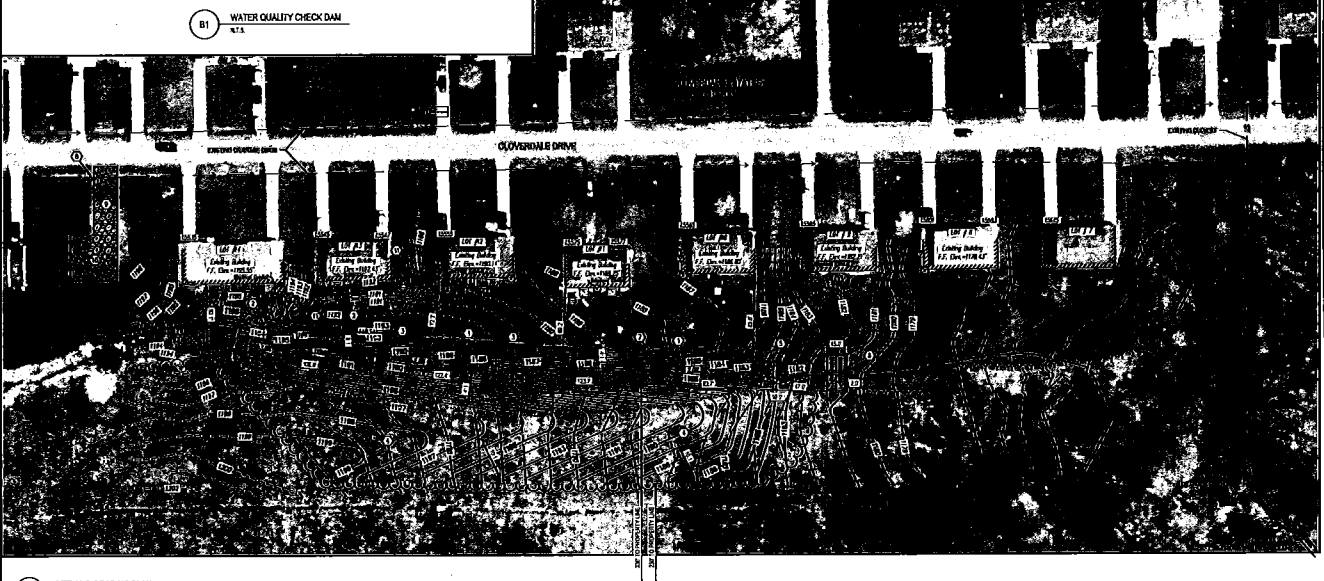

**A1 SITE AND GRADING PLAN**  
 7 of 6

**DATE:** 08/30/16

**DESCRIPTION:**

**REVISIONS:**

NO.	DATE	DESCRIPTION

**SEAL:**

**PROJECT:** CLOVERDALE ESTATES DRAINAGE  
 340 CENTER STREET, CAMPBELL, TEXAS 75008

ISSUED FOR:	DATE:
PERMIT	1/31/17
CONSTRUCTION	1/31/17
RECORD	-

**PROJECT NUMBER:** 2018359.02  
**DRAWER:** [Blank]  
**CHECKER:** [Blank]







1. SILT FENCE SHALL BE CONSTRUCTED BEFORE UPDRAINING DISTURBED AREAS.

2. ALL SILT FENCE SHALL BE PLACED AS CLOSE TO THE DISTURBED AREA AS POSSIBLE SO THAT WATER SHALL NOT CONCENTRATE TO ANY LOCATION IN THE FENCE AND IT SHALL BE BUILT TO THE FULL HEIGHT AND WIDTH SPECIFIED IN THE DRAWINGS. THE FENCE SHALL BE BUILT TO THE FULL HEIGHT AND WIDTH SPECIFIED IN THE DRAWINGS. THE FENCE SHALL BE BUILT TO THE FULL HEIGHT AND WIDTH SPECIFIED IN THE DRAWINGS.

3. TO PREVENT WATER POISED BY THE SILT FENCE FROM FLOWING AROUND THE ENDS, EACH END SHALL BE CONSTRUCTED UPWARDS SO THAT THE ENDS ARE AT A HIGHER ELEVATION.

4. WHERE POSSIBLE, SILT FENCE SHALL BE PLACED ON THE FLATTER AREA AS AVAILABLE.

5. WHERE POSSIBLE, TRENCH SHALL BE PROVIDED FOR IT TO BE HELD AS POSSIBLE SPACERS FROM THE SILT FENCE. IF A TRENCH IS REQUIRED, IT SHALL BE REESTABLISHED WITHIN 7 DAYS FROM THE INSTALLATION OF THE SILT FENCE.

6. THE HEIGHT OF THE SILT FENCE SHALL BE A MINIMUM OF 36 INCHES ABOVE THE ORIGINAL GROUND SURFACE.

7. THE SILT FENCE SHALL BE PURCHASED IN A CONTINUOUS ROLL OUT TO THE LENGTH OF THE DISTURBED AREA. THE SILT FENCE SHALL BE UNROLLLED AND STAKES SHALL BE PLACED TOGETHER ONLY AT A SUPPORT POST, 10'-0" MINIMUM ON CENTER, AND SECURELY TIED.

8. POSTS SHALL BE A MINIMUM OF 3" DIA. (LONG 1 INCHES BY SQUARE) AND SPACED A MINIMUM OF 10 FEET APART AT THE SUPPORT LOCATION AND SPACED REGULARLY IN BETWEEN. SUPPORT POSTS SHALL BE PLACED AT THE ENDS AND AT THE MID POINT OF EACH SUPPORT POST SPACING. SUPPORT POSTS SHALL BE 3" DIA. (LONG 1 INCHES BY SQUARE) AND SPACED A MINIMUM OF 10 FEET APART.

9. THE SILT FENCE SHALL BE PLACED WITHIN A TRENCH OUT A MINIMUM OF 6 INCHES DEEP. THE TRENCH SHALL BE 10 FEET WIDE AT THE TOP AND 6 INCHES WIDE AT THE BOTTOM. THE TRENCH SHALL BE REESTABLISHED WITHIN 7 DAYS FROM THE INSTALLATION OF THE SILT FENCE.

10. WHEN A TRENCH IS REQUIRED, IT SHALL BE REESTABLISHED WITHIN 7 DAYS FROM THE INSTALLATION OF THE SILT FENCE.

11. WHEN A TRENCH IS REQUIRED, IT SHALL BE REESTABLISHED WITHIN 7 DAYS FROM THE INSTALLATION OF THE SILT FENCE.

**COMPOST FILTER SOCK SPECIFICATIONS**

NATURAL TYPE	3 IN HOPE	3 1/2 IN HOPE	3 IN HOPE	3 1/2 IN HOPE	3 IN HOPE	3 1/2 IN HOPE
MINIMUM CHARACTERISTIC LENGTH OF UNITS	10 FT	10 FT	10 FT	10 FT	10 FT	10 FT
MINIMUM DIAMETER	12 IN	12 IN	12 IN	12 IN	12 IN	12 IN
MINIMUM WEIGHT	12 LB	12 LB	12 LB	12 LB	12 LB	12 LB
MINIMUM PERCENTAGE OF OPENINGS	80%	80%	80%	80%	80%	80%
MINIMUM PERCENTAGE OF OPENINGS	80%	80%	80%	80%	80%	80%

FACTORY CONDITION	1 MONTH	3 MONTHS	6 MONTHS	1 YEAR	2 YEARS
PERCENTAGE OF OPENINGS	80%	80%	80%	80%	80%
PERCENTAGE OF OPENINGS	80%	80%	80%	80%	80%

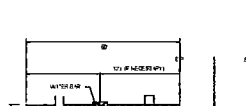

COMPOST FILTER SOCK SHALL BE PLACED AT EXISTING LEVEL OR USE. BOTH ENDS OF THE SOCK SHALL BE EXTENDED AT LEAST 10 FEET UP SLOPE AT 45 DEGREES TO THE 90 DEGREE ALIGNMENT. IN AT VERTICAL SHALL NOT BE PERMITTED TO CROSS FILTER SOCKS.

LOCAL LAND DISTURBANCE SHALL BE REMOVED AND REESTABLISHED TO THE ORIGINAL GROUND SURFACE. SOILS SHALL BE REESTABLISHED TO THE ORIGINAL GROUND SURFACE. SOILS SHALL BE REESTABLISHED TO THE ORIGINAL GROUND SURFACE. SOILS SHALL BE REESTABLISHED TO THE ORIGINAL GROUND SURFACE.

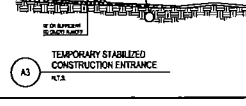

**TEMPORARY STABILIZED CONSTRUCTION ENTRANCE**

**COMPOST FILTER SOCK SPECIFICATIONS**

NATURAL TYPE	3 IN HOPE	3 1/2 IN HOPE	3 IN HOPE	3 1/2 IN HOPE	3 IN HOPE	3 1/2 IN HOPE
MINIMUM CHARACTERISTIC LENGTH OF UNITS	10 FT	10 FT	10 FT	10 FT	10 FT	10 FT
MINIMUM DIAMETER	12 IN	12 IN	12 IN	12 IN	12 IN	12 IN
MINIMUM WEIGHT	12 LB	12 LB	12 LB	12 LB	12 LB	12 LB
MINIMUM PERCENTAGE OF OPENINGS	80%	80%	80%	80%	80%	80%
MINIMUM PERCENTAGE OF OPENINGS	80%	80%	80%	80%	80%	80%

FACTORY CONDITION	1 MONTH	3 MONTHS	6 MONTHS	1 YEAR	2 YEARS
PERCENTAGE OF OPENINGS	80%	80%	80%	80%	80%
PERCENTAGE OF OPENINGS	80%	80%	80%	80%	80%

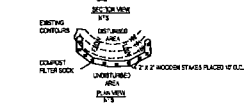

COMPOST FILTER SOCK SHALL BE PLACED AT EXISTING LEVEL OR USE. BOTH ENDS OF THE SOCK SHALL BE EXTENDED AT LEAST 10 FEET UP SLOPE AT 45 DEGREES TO THE 90 DEGREE ALIGNMENT. IN AT VERTICAL SHALL NOT BE PERMITTED TO CROSS FILTER SOCKS.

LOCAL LAND DISTURBANCE SHALL BE REMOVED AND REESTABLISHED TO THE ORIGINAL GROUND SURFACE. SOILS SHALL BE REESTABLISHED TO THE ORIGINAL GROUND SURFACE. SOILS SHALL BE REESTABLISHED TO THE ORIGINAL GROUND SURFACE. SOILS SHALL BE REESTABLISHED TO THE ORIGINAL GROUND SURFACE.



**TEMPORARY STABILIZED CONSTRUCTION ENTRANCE**

**SILT FENCE**

NATURAL TYPE	3 IN HOPE	3 1/2 IN HOPE	3 IN HOPE	3 1/2 IN HOPE	3 IN HOPE	3 1/2 IN HOPE
MINIMUM CHARACTERISTIC LENGTH OF UNITS	10 FT	10 FT	10 FT	10 FT	10 FT	10 FT
MINIMUM DIAMETER	12 IN	12 IN	12 IN	12 IN	12 IN	12 IN
MINIMUM WEIGHT	12 LB	12 LB	12 LB	12 LB	12 LB	12 LB
MINIMUM PERCENTAGE OF OPENINGS	80%	80%	80%	80%	80%	80%
MINIMUM PERCENTAGE OF OPENINGS	80%	80%	80%	80%	80%	80%

FACTORY CONDITION	1 MONTH	3 MONTHS	6 MONTHS	1 YEAR	2 YEARS
PERCENTAGE OF OPENINGS	80%	80%	80%	80%	80%
PERCENTAGE OF OPENINGS	80%	80%	80%	80%	80%

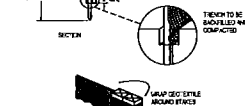

COMPOST FILTER SOCK SHALL BE PLACED AT EXISTING LEVEL OR USE. BOTH ENDS OF THE SOCK SHALL BE EXTENDED AT LEAST 10 FEET UP SLOPE AT 45 DEGREES TO THE 90 DEGREE ALIGNMENT. IN AT VERTICAL SHALL NOT BE PERMITTED TO CROSS FILTER SOCKS.

LOCAL LAND DISTURBANCE SHALL BE REMOVED AND REESTABLISHED TO THE ORIGINAL GROUND SURFACE. SOILS SHALL BE REESTABLISHED TO THE ORIGINAL GROUND SURFACE. SOILS SHALL BE REESTABLISHED TO THE ORIGINAL GROUND SURFACE. SOILS SHALL BE REESTABLISHED TO THE ORIGINAL GROUND SURFACE.

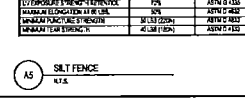

**TEMPORARY STABILIZED CONSTRUCTION ENTRANCE**

**GPD GROUP**  
 125 South Park Street, Suite 100  
 Charlotte, NC 28203  
 Phone: 704.375.1234  
 Fax: 704.375.1235  
 Email: info@gpdgroup.com  
 Website: www.gpdgroup.com

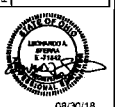

**CLOVERDALE ESTATES DRAINAGE**  
 GEORGE W. HARRIS, INC.  
 303 GARDEN STREET, CHARLOTTE, NC 28204

08/06/18

STORMWATER POLLUTION PREVENTION NOTES AND DETAILS

REVISION	DATE
1	08/06/18
2	08/06/18
3	08/06/18
4	08/06/18
5	08/06/18

PROJECT NUMBER: 2018359.02

DATE: 08/06/18

SCALE: AS SHOWN