



## The Littleton Group-Western Division Inc

---

302 North Willis, Suite 8  
Abilene, TX 79603  
(325) 676-8771 office  
(325) 676-8780 fax

Insured: Abilene Housing Authority  
Property: ID #69,2250 Vogel, Unit D20  
Abilene, TX 79602  
Business: 4398 N. 7th Street  
Abilene , TX 79602

Home: (325) 676-6032



# The Littleton Group-Western Division Inc

302 North Willis, Suite 8  
 Abilene, TX 79603  
 (325) 676-8771 office  
 (325) 676-8780 fax

**LG113001**

**SKETCH1**

**Main Level**

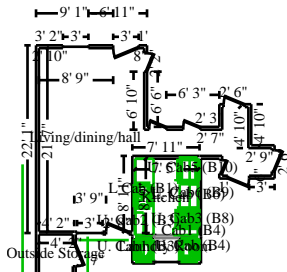

**Living/dining/hall**

**Height: 8'**

697.81 SF Walls	317.55 SF Ceiling
1015.35 SF Walls & Ceiling	317.55 SF Floor
35.28 SY Flooring	87.11 LF Floor Perimeter
108.03 LF Ceil. Perimeter	

<b>Door</b>	<b>2' 8" X 6' 8"</b>	<b>Opens into Exterior</b>
<b>Window</b>	<b>3' X 4'</b>	<b>Opens into Exterior</b>
<b>Door</b>	<b>1' 7" X 6' 8"</b>	<b>Opens into Exterior</b>
<b>Door</b>	<b>2' 6" X 6' 8"</b>	<b>Opens into Exterior</b>
<b>Door</b>	<b>2' 6" X 6' 8"</b>	<b>Opens into Exterior</b>
<b>Door</b>	<b>2' 6" X 6' 8"</b>	<b>Opens into Exterior</b>
<b>Door</b>	<b>2' X 6' 8"</b>	<b>Opens into Exterior</b>
<b>Door</b>	<b>2' X 6' 8"</b>	<b>Opens into Exterior</b>
<b>Door</b>	<b>2' 2" X 6' 8"</b>	<b>Opens into Exterior</b>
<b>Window</b>	<b>3' X 5'</b>	<b>Opens into Exterior</b>
<b>Door</b>	<b>3' X 6' 8"</b>	<b>Opens into Exterior</b>

DESCRIPTION	QUANTITY	UNIT PRICE	TAX	RCV	DEPREC.	ACV
1. Contents - move out then reset - Extra large room	1.00	EA				
2a. Remove Temporary Stud wall - 2" x 4" x 8' - 16" oc*	21.00	LF				
2b. Replace Temporary Stud wall - 2" x 4" x 8' - 16" oc*	21.00	LF				
3a. Remove Board-up penetrations*	168.00	SF				
3b. Replace Board-up penetrations*	168.00	SF				
4. Detach & Reset Heat/AC register - Mechanically attached	2.00	EA				
5a. Remove Window blind - PVC - 1" - 7.1 to 14 SF - High grade	1.00	EA				
5b. Replace Window blind - PVC - 1" - 7.1 to 14 SF - High grade	1.00	EA				
6a. Remove Aluminum window, single hung 13-19 sf	1.00	EA				
6b. Replace Aluminum window, single hung 13-19 sf	1.00	EA				
7. Replace Electrical - Labor Minimum - rewire portion of north wall*	1.00	EA				
8. Detach & Reset Light fixture	1.00	EA				
9a. Remove 1/2" drywall - hung, taped, floated, ready for paint - North and East walls*	168.00	SF				
9b. Replace 1/2" drywall - hung, taped, floated, ready for paint - North and East walls*	168.00	SF				



## The Littleton Group-Western Division Inc

302 North Willis, Suite 8  
Abilene, TX 79603  
(325) 676-8771 office  
(325) 676-8780 fax

### CONTINUED - Living/dining/hall

DESCRIPTION	QUANTITY	UNIT PRICE	TAX	RCV	DEPREC.	ACV
10a. Remove Batt insulation - 4" - R12 - unfaced batt - North and East walls*	317.55	SF				
10b. Replace Batt insulation - 4" - R12 - unfaced batt - North and East walls*	317.55	SF				
11a. Remove 1/2" drywall - hung, taped, floated, ready for paint - Ceiling*	44.00	SF				
11b. Replace 1/2" drywall - hung, taped, floated, ready for paint - Ceiling*	44.00	SF				
12a. Remove Batt insulation - 4" - R15 - paper faced	112.00	SF				
12b. Replace Batt insulation - 4" - R15 - paper faced	112.00	SF				
13. Detach & Reset Door lockset - exterior	1.00	EA				
14a. Remove Exterior door - metal - insulated - Standard grade	1.00	EA				
14b. Replace Exterior door - metal - insulated - Standard grade	1.00	EA				
15a. Remove Stud wall - 2" x 4" x 8' - 16" oc	21.00	LF				
15b. Replace Stud wall - 2" x 4" x 8' - 16" oc	21.00	LF				
16a. Remove Bottom plate - 2" x 4"	21.00	LF				
16b. Replace Bottom plate - 2" x 4"	21.00	LF				
17a. Remove Window sill	4.00	LF				
17b. Replace Window sill	4.00	LF				
18a. Remove Top plate - 2" x 4"	21.00	LF				
18b. Replace Top plate - 2" x 4"	21.00	LF				
19. Replace Acoustic ceiling (popcorn) texture	110.00	SF				
20a. Remove Baseboard - 3 1/4"	21.00	LF				
20b. Replace Baseboard - 3 1/4"	21.00	LF				
21a. Remove Quarter round - 3/4"	21.00	LF				
21b. Replace Quarter round - 3/4"	21.00	LF				
22. Seal/prime then paint the walls and ceiling (2 coats)	1,015.35	SF				
23. Seal & paint baseboard - two coats	87.11	LF				
24. Seal & paint door/window trim & jamb - (per side)	4.00	EA				
25. Seal & paint door slab only (per side)	2.00	EA				
26. Seal & paint window sill	4.00	LF				
27a. Remove Outlet	3.00	EA				
27b. Replace Outlet	3.00	EA				
28a. Remove Outlet or switch cover	3.00	EA				
28b. Replace Outlet or switch cover	3.00	EA				
29. Clean floor, strip & wax	317.55	SF				

**Totals: Living/dining/hall**



**The Littleton Group-Western Division Inc**

302 North Willis, Suite 8  
 Abilene, TX 79603  
 (325) 676-8771 office  
 (325) 676-8780 fax

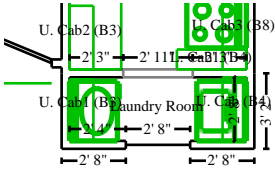

**Laundry Room**

**Height: 8'**

103.35 SF Walls	19.78 SF Ceiling
123.13 SF Walls & Ceiling	19.78 SF Floor
2.20 SY Flooring	17.25 LF Floor Perimeter
20.17 LF Ceil. Perimeter	

**Window** **2' 8 3/8" X 4'** **Opens into Exterior**  
**Missing Wall - Goes to Floor** **2' 11" X 6' 8"** **Opens into KITCHEN**

DESCRIPTION	QUANTITY	UNIT PRICE	TAX	RCV	DEPREC.	ACV
30. Detach & Reset Washer/Washing Machine - Front-loading - Standard grade	1.00	EA				
31. Detach & Reset Dryer - Electric - Standard grade	1.00	EA				
32. Seal/prime then paint the walls and ceiling (2 coats)	123.13	SF				
33. Seal & paint baseboard - two coats	17.25	LF				

**Totals: Laundry Room**

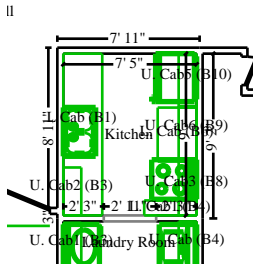

**Kitchen**

**Height: 8'**

115.65 SF Walls	66.75 SF Ceiling
182.40 SF Walls & Ceiling	38.33 SF Floor
4.26 SY Flooring	29.92 LF Floor Perimeter
32.83 LF Ceil. Perimeter	

**Missing Wall - Goes to Floor** **2' 11" X 6' 8"** **Opens into LAUNDRY\_ROOM**

DESCRIPTION	QUANTITY	UNIT PRICE	TAX	RCV	DEPREC.	ACV
34. Detach & Reset Refrigerator - top freezer - 14 to 18 cf - Standard grade	1.00	EA				
35. Seal/prime then paint the walls and ceiling (2 coats)	182.40	SF				
36. Seal & paint baseboard - two coats	29.92	LF				

**Totals: Kitchen**



**The Littleton Group-Western Division Inc**

302 North Willis, Suite 8  
 Abilene, TX 79603  
 (325) 676-8771 office  
 (325) 676-8780 fax

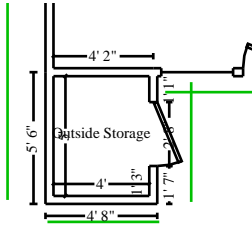

**Outside Storage**

**Height: 8'**

126.22 SF Walls	20.00 SF Ceiling
146.22 SF Walls & Ceiling	20.00 SF Floor
2.22 SY Flooring	15.33 LF Floor Perimeter
18.00 LF Ceil. Perimeter	

**Door** **2' 8" X 6' 8"** **Opens into Exterior**

DESCRIPTION	QUANTITY	UNIT PRICE	TAX	RCV	DEPREC.	ACV
37a. Remove 5/8" drywall - hung only (no tape or finish)	146.22	SF				
37b. Replace 5/8" drywall - hung only (no tape or finish)	146.22	SF				
38a. Remove Light fixture	1.00	EA				
38b. Replace Light fixture	1.00	EA				
39a. Remove Bottom plate - 2" x 4"	18.00	LF				
39b. Replace Bottom plate - 2" x 4"	18.00	LF				
40a. Remove Top plate - 2" x 4"	18.00	LF				
40b. Replace Top plate - 2" x 4"	18.00	LF				
41a. Remove Stud wall - 2" x 4" x 8' - 16" oc	18.00	LF				
41b. Replace Stud wall - 2" x 4" x 8' - 16" oc	18.00	LF				
42. Detach & Reset Door lockset - exterior	1.00	EA				
43a. Remove Exterior door - metal - insulated - flush or panel style	1.00	EA				
43b. Replace Exterior door - metal - insulated - flush or panel style	1.00	EA				
44. Seal/prime then paint the walls and ceiling (2 coats)	146.22	SF				
45. Seal & paint door/window trim & jamb - (per side)	2.00	EA				
46. Seal & paint door slab only (per side)	2.00	EA				
47a. Remove Shelving - 24" - in place	12.00	LF				
47b. Replace Shelving - 24" - in place	12.00	LF				
48. Seal & paint closet shelving - single shelf *	3.00	EA				

**Totals: Outside Storage**

**Exterior**

DESCRIPTION	QUANTITY	UNIT PRICE	TAX	RCV	DEPREC.	ACV
49a. Remove Exterior trim board - 1" x 6"*	25.00	LF				
49b. Replace Exterior trim board - 1" x 6"*	25.00	LF				
50. Detach & Reset Brick veneer	150.40	SF				
51. Replace Brick - Add for rowlock course	5.00	LF				
52a. Remove House wrap (air/moisture barrier)	150.40	SF				
52b. Replace House wrap (air/moisture barrier)	150.40	SF				



**The Littleton Group-Western Division Inc**

302 North Willis, Suite 8  
Abilene, TX 79603  
(325) 676-8771 office  
(325) 676-8780 fax

**CONTINUED - Exterior**

DESCRIPTION	QUANTITY	UNIT PRICE	TAX	RCV	DEPREC.	ACV
53a. Remove Brick lintel - steel	12.00	LF				
53b. Replace Brick lintel - steel	12.00	LF				
54a. Remove Rigid foam insulation board - 1"	150.40	SF				
54b. Replace Rigid foam insulation board - 1"	150.40	SF				
55. Replace Temporary shoring post - Screw jack (per day)	12.00	DA				
56. Seal & paint trim - two coats	25.00	LF				

**Totals: Exterior**

**Miscellaneous**

DESCRIPTION	QUANTITY	UNIT PRICE	TAX	RCV	DEPREC.	ACV
57. Replace Tarp - all-purpose poly - per sq ft (lab/mat) - after hrs	168.00	SF				
58. Dumpster load - Approx. 12 yards, 1-3 tons of debris	1.00	EA				

**Totals: Miscellaneous**

**Total: Main Level**

**Total: SKETCH1**

**Labor Minimums Applied**

DESCRIPTION	QUANTITY	UNIT PRICE	TAX	RCV	DEPREC.	ACV
59. Plumbing labor minimum*	1.00	EA				
60. Window treatment repair*	1.00	EA				
61. Finish hardware labor minimum*	1.00	EA				
62. Window labor minimum*	1.00	EA				
63. Heat, vent, & air cond. labor minimum*	1.00	EA				

**Totals: Labor Minimums Applied**

**Line Item Totals: LG113001**



## The Littleton Group-Western Division Inc

---

302 North Willis, Suite 8  
Abilene, TX 79603  
(325) 676-8771 office  
(325) 676-8780 fax

### Grand Total Areas:

1,043.03	SF Walls	424.07	SF Ceiling	1,467.10	SF Walls and Ceiling
395.65	SF Floor	43.96	SY Flooring	149.61	LF Floor Perimeter
0.00	SF Long Wall	0.00	SF Short Wall	179.03	LF Ceil. Perimeter
395.65	Floor Area	475.61	Total Area	1,043.03	Interior Wall Area
958.77	Exterior Wall Area	128.20	Exterior Perimeter of Walls		
0.00	Surface Area	0.00	Number of Squares	0.00	Total Perimeter Length
0.00	Total Ridge Length	0.00	Total Hip Length		

